

REINFORCEMENT BARS				
QTY.	SIZE	CUTTING LENGTH	MARK	BENDING DIAGRAM ALL DIMENSIONS OUT TO OUT
84	#6	18'-0" [5486]	S1	
9	#4	5'-4 3/4" [1645]	S2	
32	#6	10'-0" [3048]	S3	

REVISIONS			
REV	DESCRIPTION	DATE	APPROVED
A	ORIGINAL RELEASE	09/08/95	KLL/JDH
B	ECR 96-0833; DEL ITEM 10 FROM 009946-01.	05/31/96	MSS/KLL
C	ECR 99-0565; CHNG PAD DIM. FROM 16'-6"	03/12/99	MWC/JRK
C1	EC 03-0984; ITEM 001 WAS V11061-1.	10/22/03	KBN/KLL
D	EC 04-0477; BUMP ALPHA-NUMERIC REV.	05/26/04	KLL
E	EC 04-0814; UPGRADE FOUNDATION TO ELIMINATE 1.33 WIND STRESS RELIEF	08/26/04	RRY/SPK
F	EC 05-0314	04/04/05	JJL/VKV

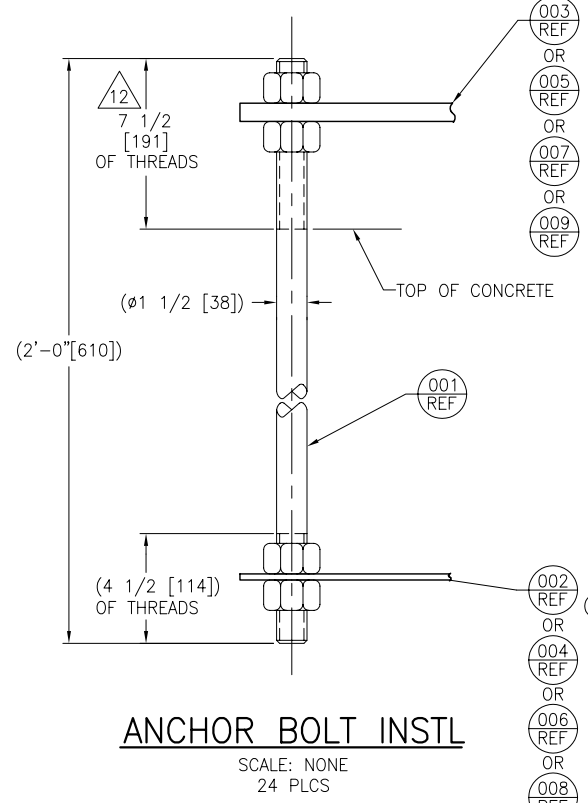

- NOTES:**
- ALL CONCRETE SHALL HAVE A 28-DAY MIN. COMPRESSION STRENGTH OF 3,000 PSI. [20.7 MPa]
 - CONCRETE SHALL BE THOROUGHLY CONSOLIDATED BY EITHER RODDING OR VIBRATING.
 - REINFORCEMENT STEEL SHALL BE DEFORMED INTERMEDIATE GRADE NEW BILLET STEEL BARS WITH 60,000 PSI [414MPa] MIN. YIELD STRENGTH IN ACCORDANCE WITH SPECIFICATION FOR DEFORMATION OF DEFORMED STEEL BARS FOR CONCRETE REINFORCEMENT (A.S.T.M. A-615).
 - ALL REINFORCEMENT BARS SHALL BE SECURELY WIRED TO PREVENT SHIFTING WHEN CONCRETE IS PLACED.
 - THE BASE UNDER THE FOUNDATION SHALL CONSIST OF UNDISTURBED (OR COMPACTED) MATERIAL WITH A MINIMUM BEARING CAPACITY OF 2,000 PSF [95.76 kPa].
 - SURFACE TO HAVE A BROOM FINISH AND BE LEVEL TO THE HORIZON WITHIN ±1/8"[3].
 - WHEN THE FROST-LINE IS BELOW 17"[432], THE SUB-SOIL BASE REQUIRES SPECIAL DESIGN CONSIDERATION TO PREVENT HEAVING.
 - COMPLIANCE WITH ALL BUILDING CODES AND THE REQUIRED PERMITS ARE THE RESPONSIBILITY OF OTHERS.
 - ANCHOR BOLT PATTERNS SHALL BE LOCATED WITHIN ±1/8"[3] OF SPECIFIED LOCATIONS.
 - ESTIMATED QUANTITIES: CONCRETE: 16.1 CU. YDS. [12.7 M³].
STEEL: 2785 LB. [1263 Kg].
 - WIND SURVIVAL: 125 MPH [200 KPH].
 - PROTECT EXPOSED THREADS FROM CONCRETE SPLATTER DURING PLACEMENT OF CONCRETE. REMOVE WOODEN TEMPLATES AND HEX NUTS 24 HOURS AFTER PLACEMENT OF CONCRETE AND CLEAN ALL EXPOSED THREADS.
 - METRIC EQUIVALENTS IN [] (MILLIMETERS).

QTY	ITEM NO.	PART OR IDENTIFYING NO.	NOMENCLATURE OR DESCRIPTION	NOTES
1	009	R003022	TEMPLATE, FDTN ANCHOR BOLT (LEG)	
1	008	R003021	PLATEWASHER, FDTN ANCHOR BOLT (LEG)	
2	007	R003020	TEMPLATE, FDTN ANCHOR BOLT (TRUNNION)	
2	006	R003019	PLATEWASHER, FDTN ANCHOR BOLT (TRUNNION)	
1	005	R003018	TEMPLATE, FDTN ANCHOR BOLT (PINTLE)	
1	004	R003017	PLATEWASHER, FDTN ANCHOR BOLT (PINTLE)	
2	003	R003016	TEMPLATE, FDTN ANCHOR BOLT (LEG)	
2	002	R003015	PLATEWASHER, FDTN ANCHOR BOLT (LEG)	
24	001	V11061-9	BOLT ASSY ANCHOR 1 1/2-6UNC X 24	
-01				

DO NOT SCALE DRAWING		REFERENCE SEPARATE BOM FOR SPECIFIC INFO		LIST OF MATERIALS OR PARTS LIST	
UNLESS OTHERWISE SPECIFIED ! INTERPRET DIMENSIONING & TOLERANCING PER ASME Y14.5M-1994. DIMENSIONS ARE IN INCHES. DIMENSIONS SHOWN IN () ARE FOR REFERENCE ONLY. TOLERANCES ARE: FRACTIONS: DETAILS ± 1/16 ASSY'S ± 1/8 DECIMALS: .XX ± .03 .XXX ± .005 ANGLES ± 1'		DESIGN	DATE	APPROVALS	DATE
UNLESS OTHERWISE SPECIFIED ! PART TO BE FREE OF BURRS & SHARP EDGES. COMMERCIAL TOLERANCES TO STOCK SIZES APPLY.		MECHANICAL		CHECKED JD HENDRIX	09/08/95
TO CONVERT TO METRIC SYSTEM, MULTIPLY INCHES SHOWN ON DRAWING BY 25.4 TO OBTAIN MILLIMETERS.		STRUCTURAL	09/08/95	DESIGNER JD HENDRIX	09/08/95
		ELECTRICAL		MANUFACTURING DD DAVIS	09/08/95
				PROJECT S LUCY	09/08/95
				PRODUCT MGR	
		VertexRSI CONFIDENTIAL AND PROPRIETARY		 ANTENNA PRODUCTS 2600 N. LONGVIEW ST. KILGORE, TEXAS 75662 USA	
		FOUNDATION INSTL 6KX 200 2 POS, 125 MPH		TITLE:	
		CODE ID. NO.	SIZE	DWG. NO.	REV
		1GD22	D	009946	F
		SCALE: 1/20	CONTRACT NO. 9511	SHEET 1 OF 1	

DFORM1D1