

THIS DRAWING IS A SOURCE CONTROL DRAWING AND IS PROPRIETARY TO MICROWAVE FILTER CO., INC. AND MAY NOT BE DUPLICATED OR DISTRIBUTED WITHOUT WRITTEN PERMISSION OF MICROWAVE FILTER CO., INC. THIS DRAWING ALSO DESCRIBES TRADE SECRETS AND IS THE EXCLUSIVE PROPERTY OF MICROWAVE FILTER CO., INC

REVISION			
LTR	ECN	DATE	APPR'D
B	3749	8/04	MW
C	4080	5/08	PMB
D	4273	5/11	PMB

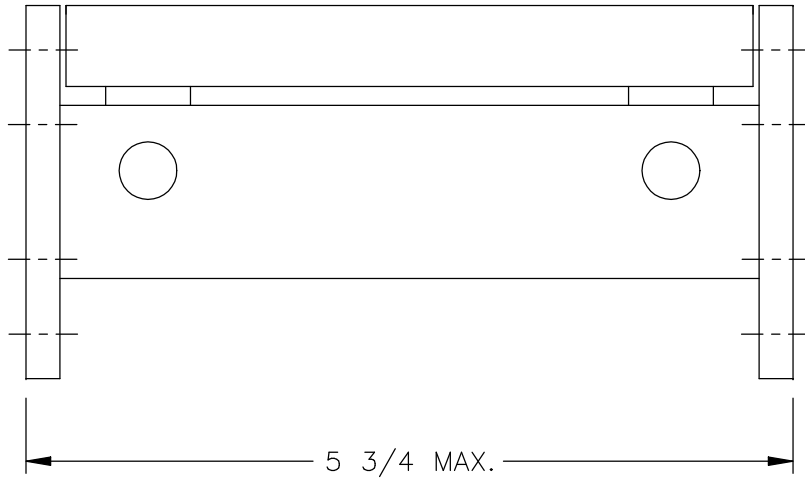

← INPUT

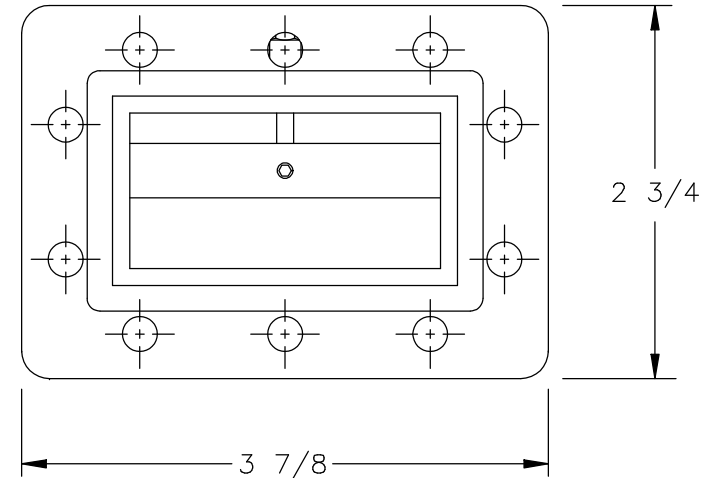

SPECIFICATIONS

PASSBAND: 3.7 – 4.2 GHz.  
 INSERTION LOSS: 0.4 dB TYP. @ Fo  
 0.5 dB ROLL OFF @ BAND EDGE  
 VSWR: 1.44:1 MAX  
 RETURN LOSS: 15 dB MIN  
 GROUP DELAY: LESS THAN 8 ns TYP

REJECTION:	FREQUENCY:
25 dB MIN.	3.65, 4.25 GHz
60 dB MIN.	3.55, 4.35 GHz
70 dB MIN.	3.50, 4.40 GHz

WEIGHT: 2.5 lbs  
 FLANGES: CPR229G (INPUT)  
 CPR229F (OUTPUT)  
 \* HALF GASKET SUPPLIED W/ EACH MODEL

UNLESS SPECIFIED  
 ALL TOLERANCES ±.030

ENVELOPE DRAWING

<b>MFC</b> MICROWAVE FILTER CO. INC. 6743 KINNE ST. E. SYRACUSE, N.Y. 13057		FSCM27834	
DATE	5/92	TITLE	
DWN BY	M.W.	BANDPASS FILTER	
ENGINEER	CFF Jr.	SIZE	B
		DRAWING NO.	7893D
		REV	D