

ADVANCED SWITCH TECHNOLOGY WR137 SWITCH

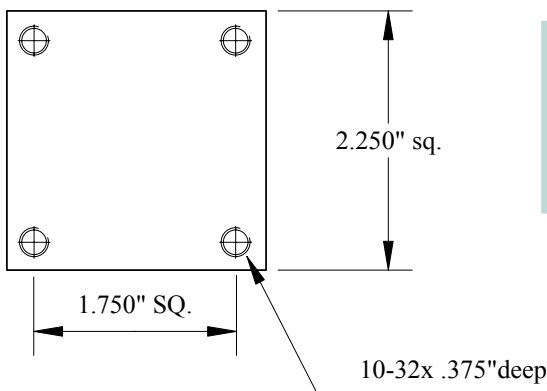
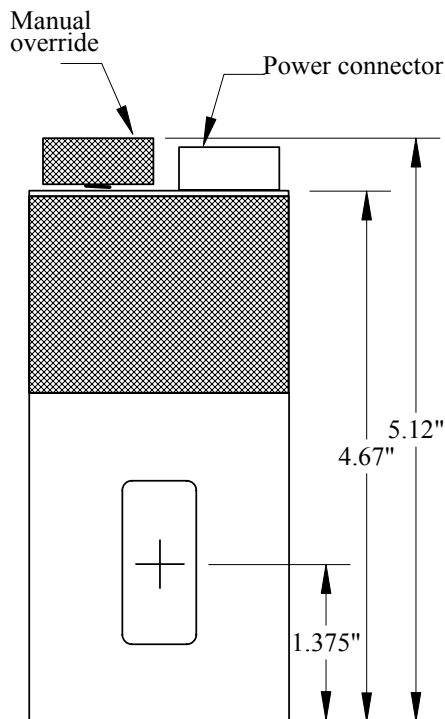
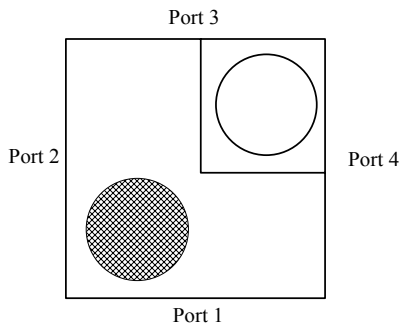

ELECTRICAL SPECIFICATIONS

Frequency range	: 5.85-8.2 GHZ
Return loss	: -30 db
Isolation	: 70 db typ.
Insertion loss	: .05 db Max.
Power handling	: 6 Kw CW
Driving voltage	: OPTIONAL
C form contacts	: 4 in standard unit
Switching time	: 80 msec
Power connector	: ITT KPT02614-19P Mating connector provided

MECHANICAL SPECIFICATIONS

Waveguide size	: WR137
Pressure capability	: 20 PSIG including driving head
Finish:	: Iridite on wg. and flanges Black anodize on driving head
Weight	: .750 Kg

ENVIRONMENTAL SPECIFICATIONS

Operating temperature	: -40 to +75 Deg.C
Non oper. temperature	: -50 to +100 Deg.C
Humidity	: 100 %
Shock and vibration	: As encountered in standard transportation

MODEL No : AST137