

8

7

6

5

4

3

2

1

NOTES: UNLESS OTHERWISE SPECIFIED
 1- WORKMANSHIP PER CMP STANDARD QA500/M.
 2- DIMENSIONS IN [XX] ARE IN mm.

REVISIONS					
REV	DESCRIPTION	DRAWN	CHKD	DES./MFG. AUTH	DATE
B	REVISED PER CO-24699	AS	WS	A.THEMANN	05AUG22

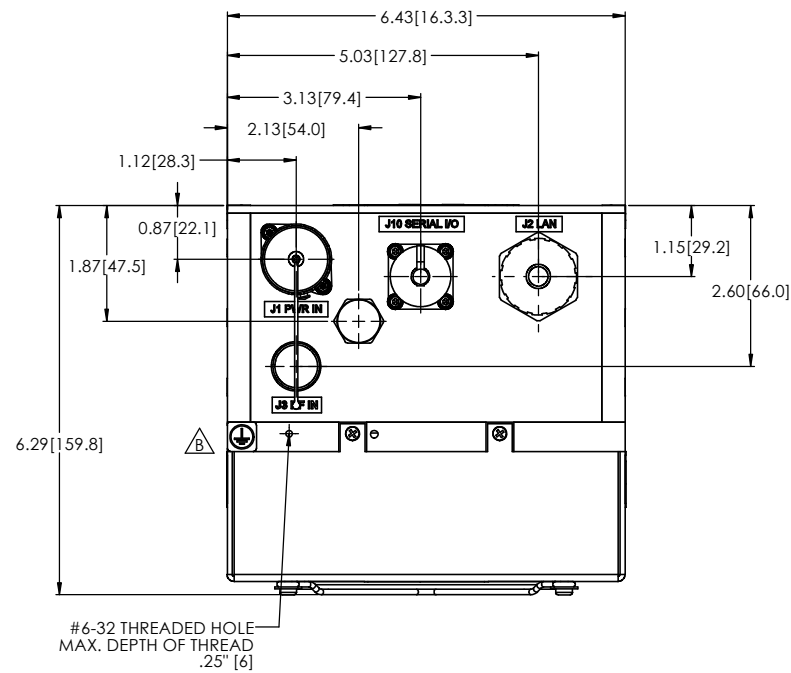

#6-32 THREADED HOLE
 MAX. DEPTH OF THREAD
 .25" [6]

3 PER SIDE #8-32 X 1.5 DIA THREADED INSERT
 MAX DEPTH OF THREAD PENETRATION .40" [10]

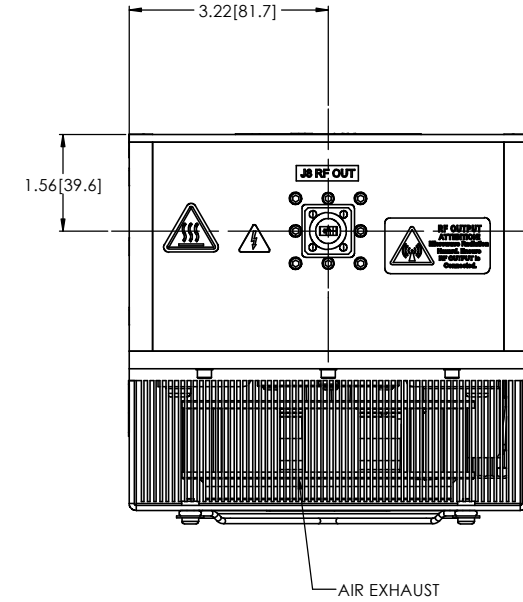
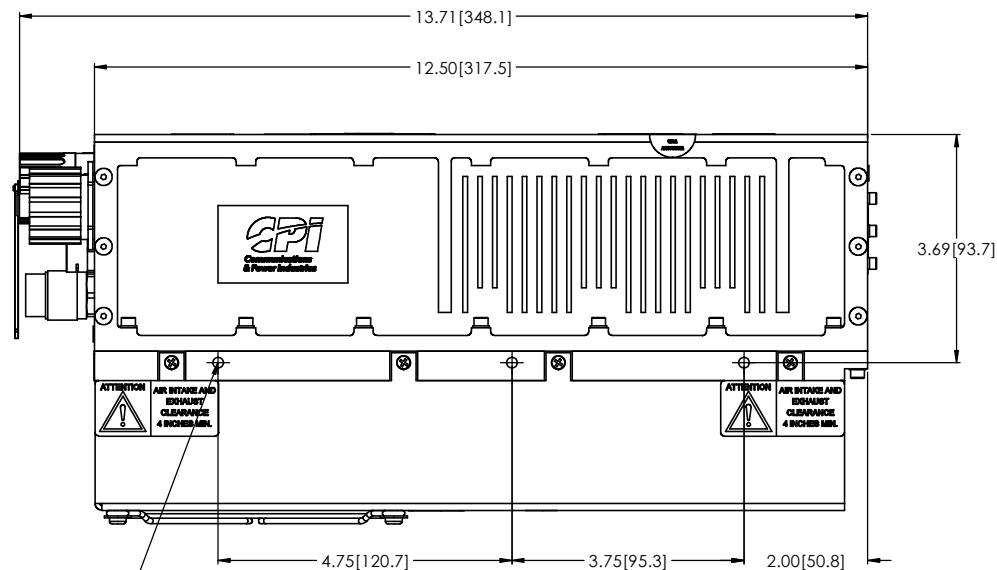

TOP SURFACE

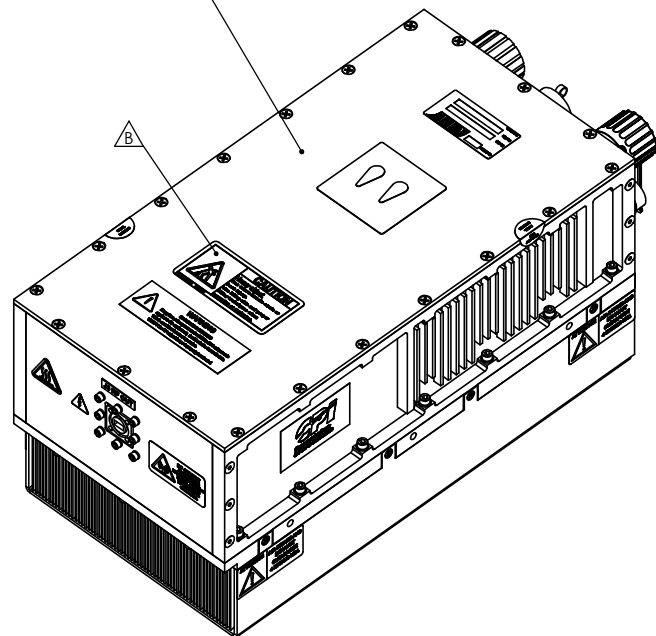

BOTTOM SURFACE

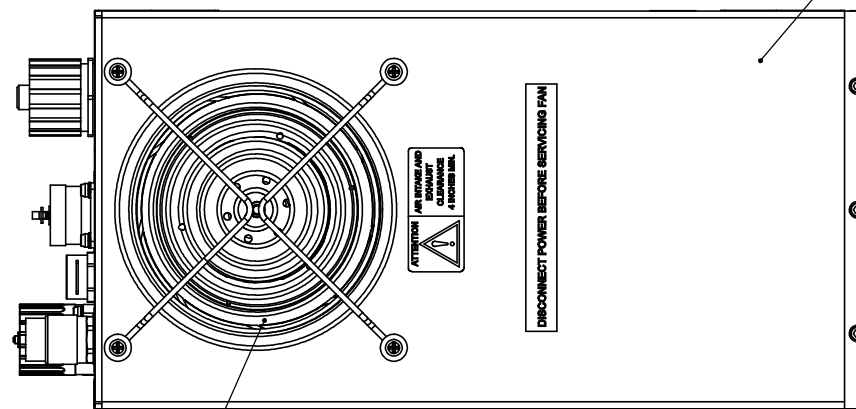

AIR INTAKE

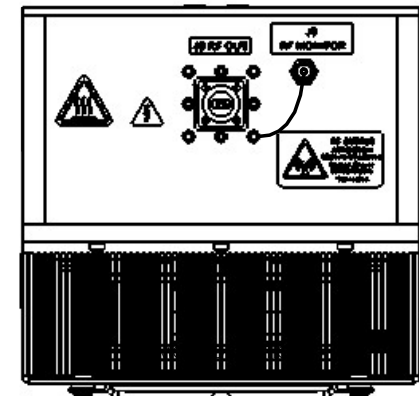

RF MONITOR OPTION

PROPRIETARY AND CONFIDENTIAL

THE INFORMATION CONTAINED IN THIS DRAWING IS PROPRIETARY TO COMMUNICATIONS & POWER INDUSTRIES INC. (CPI). HAS BEEN DESIGNED AND DEVELOPED AT PRIVATE EXPENSE, AND IS OWNED BY CPI. DISCLOSURE, USE, OR REPRODUCTION IS PROHIBITED IN WHOLE OR IN PART WITHOUT THE EXPRESS WRITTEN PERMISSION OF CPI. ALL RIGHTS RESERVED.

	UNLESS OTHERWISE SPECIFIED DIMENSIONS ARE IN INCHES. TOLERANCES ARE: FRACTIONS: ± --- DECIMALS: X ± --- .XX ± .02 .XXX ± .005 .XXXX ± --- ANGLES: ± 1° MATERIAL:	DRAWN BY: W. STERLI DESIGN ENGINEER: W. STERLI DATE: 08JAN21 APPROVALS: [Signature] DATE: 08JAN21 PRODUCTION ENGINEER: C. DAVIS DESIGN/MANUFACTURING AUTH: A. THEMANN DATE: 08JAN21 SURFACE FINISH: [Symbol] PROJECTION: [Symbol]	Communications & Power Industries Canada Inc. TITLE OUTLINE, SB49K0A
NEXT ASSEMBLY	USED ON	DO NOT SCALE DRAWING	CODE IDENT: 02845 SIZE: D DRAWING No.: 01-000955 REV: B

APPLICATION DWG LEVEL: 2 SCALE: NTS SHEET 1 OF 2

8

7

6

5

4

3

2

1

8

7

6

5

4

3

2

1

NOTES: UNLESS OTHERWISE SPECIFIED

REVISIONS					
REV	DESCRIPTION	DRAWN	CHKD	DES/MFG AUTH	DATE
-	See Sheet1	-	-	-	-

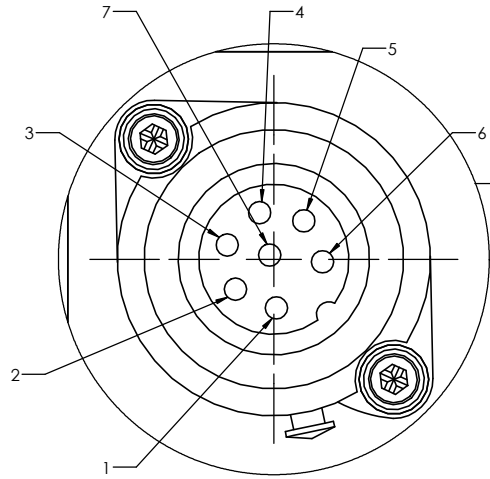

DETAIL A
CAP REMOVED FOR CLARITY
CONNECTOR SHOWN FROM OUTSIDE OF THE UNIT

J1 PIN No.	FUNCTION
1	RTN INPUT
2	N/C
3	RTN INPUT
4	+INPUT
5	N/C
6	+INPUT
7	CHASSIS GND

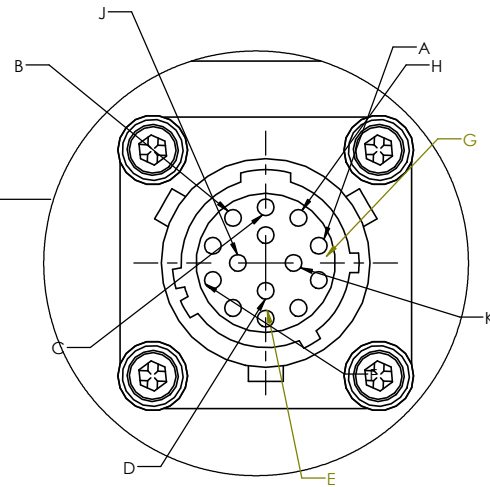
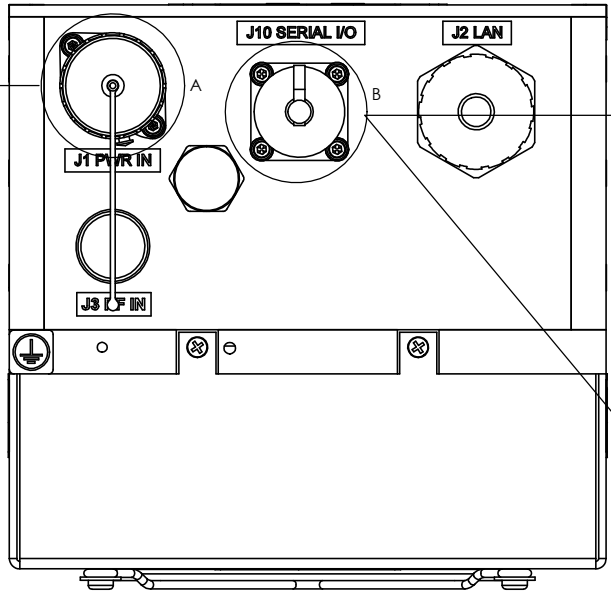

DETAIL B
CAP REMOVED FOR CLARITY
CONNECTOR SHOWN FROM OUTSIDE OF THE UNIT

PIN 10 No.	FUNCTION
A	485 TX (+)
B	485 TX (-)
C	485 GND
D	485 RX (-)
E	485 (+)
F	232 TX
G	232 RX
H	232 GND / MUTE RTN
J	MUTE
K	232 GND / MUTE RTN

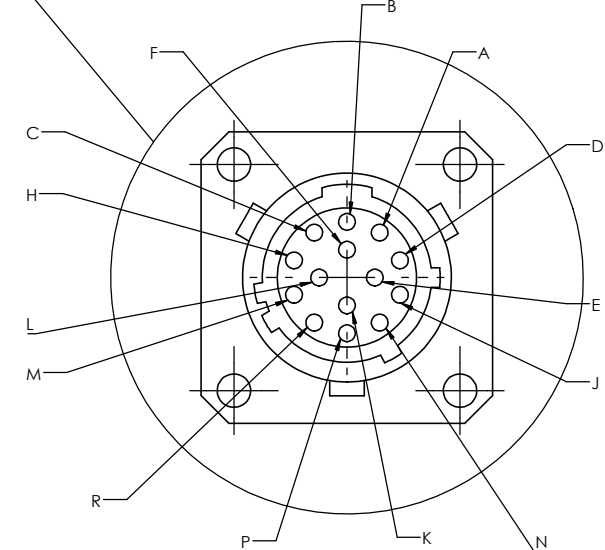

DETAIL B (OPTION)
CAP REMOVED FOR CLARITY
CONNECTOR SHOWN FROM OUTSIDE OF THE UNIT

PIN 10 No.	FUNCTION
A	485 TX (+)
B	485 TX (-)
C	485 GND
D	485 RX (-)
E	485 RX (+)
F	232 TX
H	232 RX
J	232 GND / MUTE RTN
K	MUTE
L	KEYLINE (+)
M	KEYLINE (-)
N	FAULT NC
P	FAULT COM
R	FAULT NO

REF DESIGNATORS	CONNECTOR TYPE	MATING CONNECTOR	FUNCTION
J1	CONNECTOR, RECEPTICAL - CIRCULAR 6 CIRCUIT, CRIMP, BULKHEAD MOUNT AMPHENOL C016 10C006 000 12	CONNECTOR, PLUG - CIRCULAR 6 CIRCUIT, CRIMP, AMPHENOL CO16 10D00G 000 12 CRIMP PIN CN02 016 0002(1)	DC INPUT POWER
J2	RJ45 JACK CONEC 17-10000	RJ45 PLUG CONEC 17-10001	LAN 10BASE-T
***J3	N TYPE FEMALE	N TYPE MALE	RF INPUT
J8	WR28 GROOVED WITH 4-40 UNC HOLES	WR28 COVER FLANGE WITH CLEAR HOLES	RF OUTPUT
J9 (OPTION)	2.92mm FEMALE	2.92mm MALE	RF MONITOR
J10	AMPHENOL PT02E12-10S(25)	AMPHENOL PT06E12-10P(470)	SERIAL I/O
J10 (OPTION)	AMPHENOL PT02E12-14S(025)	AMPHENOL PT06E12-14P(470)	SERIAL I/O

*** NOTE: TYPE-N (SHOWN) FOR L-BAND INPUT, 2.92mm FOR Ka-BAND INPUT DEPENDING ON OPTION.

PROPRIETARY AND CONFIDENTIAL

THE INFORMATION CONTAINED IN THIS DRAWING IS PROPRIETARY TO COMMUNICATIONS & POWER INDUSTRIES INC. (CPI). HAS BEEN DESIGNED AND DEVELOPED AT PRIVATE EXPENSE, AND IS OWNED BY CPI. DISCLOSURE, USE, OR REPRODUCTION IS PROHIBITED IN WHOLE OR IN PART WITHOUT THE EXPRESS WRITTEN PERMISSION OF CPI. ALL RIGHTS RESERVED.

UNLESS OTHERWISE SPECIFIED DIMENSIONS ARE IN INCHES. TOLERANCES ARE: FRACTIONS: ± --- DECIMALS: X ± --- .XX ± .02 .XXX ± .005 .XXXX ± --- ANGLES: ± 1° MATERIAL:	DRAWN BY: AS DESIGN ENGINEER: W. STERLI DATE: 08JAN21 APPROVALS: C. DAVIS PRODUCTION ENGINEER: A. THEMANN DESIGN/MANUFACTURING AUTH: 08JAN21 SURFACE FINISH: <input checked="" type="checkbox"/> <input type="checkbox"/> PROJECTION: <input checked="" type="checkbox"/> <input type="checkbox"/>	Communications & Power Industries Canada Inc. TITLE OUTLINE, SB49K0A CODE IDENT: 02845 SIZE: D DRAWING No.: 01-000955 REV: B
---	---	--

DO NOT SCALE DRAWING

8

7

6

5

4

3

2

1